



Congratulations, you have purchased the finest exhaust system for your motorcycle on the market. Your Vance & Hines exhaust system is designed and crafted for maximum performance, a perfect fit, a great sound and unbeatable style. Please follow the installation instructions below and if you have any questions, please call our technical support line at (562) 926-5291.

Attention installer (if other than owner), please forward this instruction sheet to the owner of this product. These instructions contain valuable information to the end user.

BEFORE YOU BEGIN

- Make sure your bike is on a flat and stable surface before beginning this install.
- Before you start work make sure you have protective clothes and eye wear.
- You will need the following tools to perform the installation:
 - 10, & 12mm sockets and ratchet
 - 10 & 12mm Combination wrenches
 - 4 & 5mm Allen wrenches

READ ALL INSTRUCTIONS BEFORE BEGINNING INSTALLATION

STOCK EXHAUST SYSTEM REMOVAL

1. Remove 3 screws holding OE heat shield on. (Figure 1) (this heat shield is not reused)
2. Remove 2 cables on muffler body that control exhaust valve. (Figure 2)
3. Loosen V-band clamp that connects muffler to mid-pipe. (Stock V-band clamp is not used on new exhaust.)
4. Remove bolt that connects muffler to foot peg mount. (Save bolt)
5. Remove stock muffler, stock exhaust gasket and V-band clamp.

VANCE & HINES OPTIONAL ACCESSORIES

FUELPAK



Take the guess work out of fuel injection with Fuelpak Fuel Management. Visit fuelpakfi.com for more information and to find out if your application is supported. Contact your local dealer or call (562) 921-0071 to order. Fuelpak is intended for racing or off-highway use only, and is not legal for sale or use in California on pollution-controlled vehicles.

SPARE PARTS & ACCESSORIES

1. 1 - 1/2" Sound lowering Right Insert P/N: A180SN-R
2. 1 - 1/2" Sound lowering Left Insert P/N: A181SN-R
3. 1 - 5/8" Sound lowering Right Insert P/N: A175SN-R
4. 1 - 5/8" Sound lowering Left Insert P/N: A176SN-R
5. 1 - 7/8" Sound lowering Right Insert P/N: A165SN-R
6. 1 - 7/8" Sound lowering Left Insert P/N: A166SN-R
7. 1 - 3/4" Sound lowering Right Insert P/N: A170SN-R
8. 1 - 3/4" Sound lowering Left Insert P/N: A171SN-R
9. Muffler Re-Pack P/N: A240FG-R

FIGURE 1



FIGURE 2



FIGURE 3

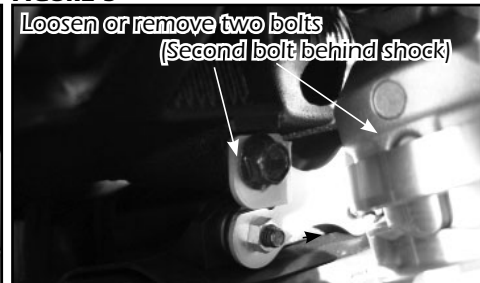
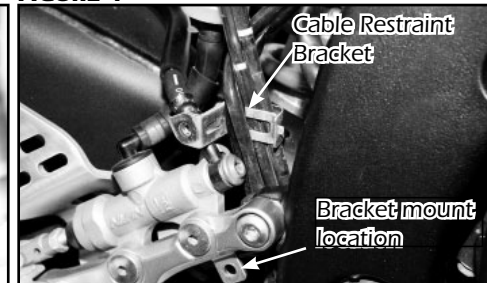
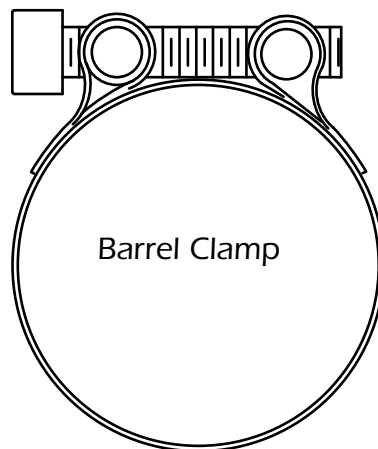

FIGURE 4



1. Slide provided barrel band clamp over inlet of new muffler, hex side down. Slip the inlet onto stock mid-pipe until muffler body mounting bracket lines up with the inside of the stock foot peg mounting hole.
2. Insert the stock bolt through the foot peg mounting hole and muffler body mounting bracket and attach with the provided nut. Adjust barrel band clamp so that barrel is out of sight in back and tighten clamp.
3. Loosen or remove two bolts holding servo in place to allow access to cables. Servo is located in front of rear shock. (Figure 3) Remove both servo cables from servo unit. Reattach servo unit, tighten securely. Do not remove servo permanently or run bike with servo electronically disconnected because an error code will result.
4. Remove cable restraint bracket (shown removed in Figure 4), pull apart outer and inner restraint bracket pieces and remove servo cables from motorcycle entirely. Re-attach bracket.
5. After installation and before starting your motorcycle, completely clean pipes and heat shields with warm soapy water and a clean soft cloth. Dry with a clean towel. NOTE: any residue, oil, or fingerprints will stain the finish. Do NOT use anything abrasive to clean the pipes as it may remove the finish.
6. Be sure to tighten all hardware before starting your motorcycle.

PACKING LIST



PARTS NOT SHOWN:

| | |
|--------|----------------------------------|
| Y755RB | Right tail pipe(SS) |
| Y757RP | Right tail pipe(Black) |
| A165SN | 1.875" Right insert (in muffler) |
| A170HW | 8MM x 1.25 x12MM Hex Nut |

WARRANTY

All of our exhaust systems are warranted against defects in material and/or workmanship for a period of 90 days. This warranty shall be limited to the repair or replacement of the system, which may be proven defective under normal use. We will not warranty any system that has been abused, misused, improperly installed, or modified. Failure to follow muffler packing instructions and maintenance will also not be covered under warranty.