

INSTALLATION INSTRUCTIONS: HARLEY-DAVIDSON 2018 FAT BOY / BREAKOUT PASSENGER FOOTPEG RELOCATOR KIT PART# 16943

Congratulations, you have purchased the finest footpeg relocation system for your motorcycle on the market. Your Vance & Hines footpeg relocater is designed and crafted for maximum performance and a perfect fit. Please follow the installation instructions below and if you have any questions, please call our technical support line at (562) 926-5291.

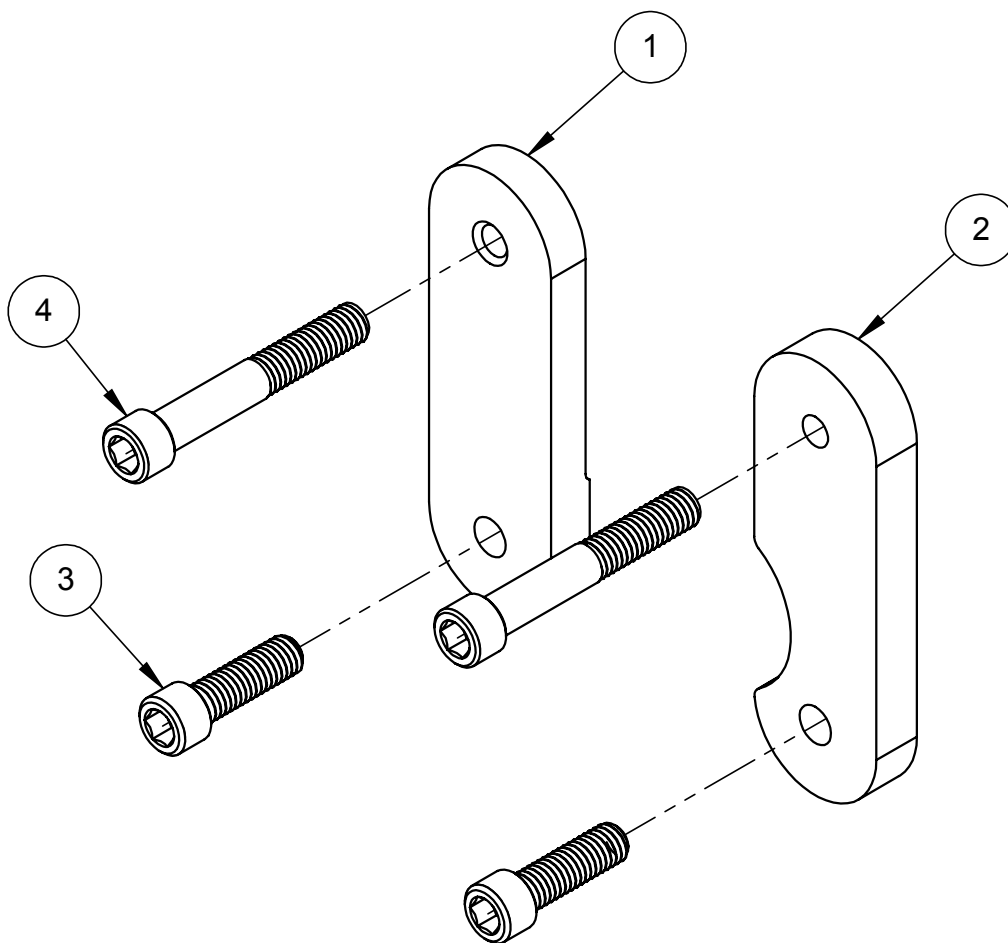

PARTS LIST

NO.	PART NO.	Description	Qty.
1	1146-A	Right side footpeg relocater	1
2	1147-A	Left side footpeg relocater	1
3	A840HW	3/8-16 x 1 1/4" SHCS	2
4	A101HW	3/8-16 x 2 1/2" SHCS	2

TOOLS REQUIRED

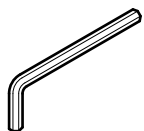

**Allen Wrenches: 5/32",
5/16"
Torx: T45**

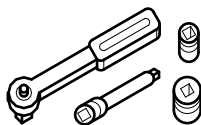

**Ratchet & Extensions:
Sockets: 1/2"**

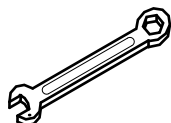

**Combination Wrench:
1/2"**

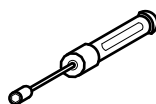

Nutdriver: 5/16"

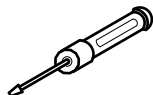

Screwdrivers: Flat Blade

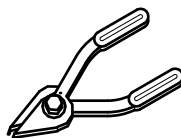

Circlip Pliers

INSTALLATION OF FOOTPEG RELOCATOR

1. For a clear understanding of this installation, it is best to refer to the exploded view diagram while reading these instructions.
2. Locate the rear O2 sensor connector. Remove the two bolts holding the right side cover in place and gently pull cover off bike. **NOTE:** Pay attention to the wire routing for re-installation.
3. Locate the front O2 sensor connector. Unplug the sensor and feed the end of the wire through the frame, freeing it from the motorcycle.
4. Loosen the right-hand floor board mounting bolts to gain clearance for the exhaust removal and installation.
5. Loosen the heat shield clamps on both the front and rear exhaust pipes.
6. Remove the the two mounting nuts from each head pipe, located at the cylinder head.
7. The right side footpeg will need to be removed from the stock mounting bracket. Remove the clip holding the footpeg pin in place. Removing the pin and footpeg will expose a screw. Loosen to uninstall the footpeg from the mount bracket. Repeat this process on the left side footpeg if still installed to frame.
8. When installing footpeg relocators apply Loctite 243 (blue) to the threads of all fasteners.
9. Mount the left side footpeg relocator 1147-A to the frame using the supplied 3/8-16 x 1-1/4" screw. Install the footpeg mounting rod to the relocator using the supplied 3/8-16 x 2-1/2" screw. Reinstall the footpeg to the mounting rod using the stock pin and clip. See **Figure 1**.
10. Repeat this process with the right side footpeg relocator 1147-A. **NOTE:** The right side footpeg mounting rod and footpeg will need to be installed after the exhaust system has been re-installed.
11. Re-install the front header and heat shield assembly into the exhaust port first. Bolt the header to the muffler bracket second. Leave loose at this time.
12. Re-install the rear header and heat shield assembly into the exhaust port first. Bolt the header to the muffler bracket second. Leave loose at this time.
13. Tighten all hardware and heat shield clamps.
14. Route O2 sensor wires away from hot areas of the motorcycle. Plug the O2 sensor wires back into the wiring.
15. Install the right side footpeg mounting rod and footpeg onto the footpeg relocator. See **Figure 2**.
16. Re-install and tighten the floor board mounting bolts.
17. Be sure to tighten all hardware before starting your motorcycle.
18. After installation and before starting the motorcycle, completely clean pipes and mufflers with soap and water and a clean soft cloth. **NOTE:** Any residue, oil, or fingerprints will stain the finish when the exhaust heats up.

Figure 1



Figure 2



Warranty:

All Vance & Hines products are warranted against defects in material and workmanship for a period of 90 days. This warranty does not cover discoloration or rust. This warranty shall be limited to the repair or replacement of the product, which may be proven defective under normal use. Vance & Hines will not warranty any system that has been abused, misused, improperly installed or modified.

Dealers or distributors are not authorized to make dispositions binding upon Vance & Hines. Vance & Hines will not be responsible for any labor charges incurred in removing or replacing any system under warranty. A return authorization number and a copy of the original purchase invoice must accompany all returns. Parts returned without a return authorization may be refused.

13861 ROSECRANS AVENUE / SANTA FE SPRINGS, CA 90670

SALES: (562) 921-5388

TECHNICAL: (562) 926-5291

FAX: (562) 802-0110

vanceandhines
.com