



Congratulations, you have purchased the finest exhaust system for your motorcycle on the market. Your Vance & Hines exhaust system is designed and crafted for maximum performance, a perfect fit, a great sound and unbeatable style. Please follow the installation instructions below and if you have any questions, please call our technical support line at (562) 926-5291.

Attention installer (if other than owner), please forward this instruction sheet to the owner of this product. These instructions contain valuable information to the end user.

BEFORE YOU BEGIN

- It's always a good idea to clean your bike if you have been riding it.
- Before you start work make sure you have protective clothes and eyewear.
- You will need the following tools to perform the installation: 8, 10 & 12mm T-Handles and 6mm Allen T-handle.

READ ALL INSTRUCTIONS BEFORE BEGINNING INSTALLATION

STOCK EXHAUST SYSTEM REMOVAL AND XCR INSTALLATION

REMOVING YOUR STOCK SYSTEM

1. Place the machine on a stable work stand.
2. If you are not familiar with removing the original exhaust refer to the owner's manual before you start work.
3. Always allow your machine to cool down before attempting to remove the exhaust.
4. Remove the two bolts from the right side panel. Then remove the side panel.
5. Loosen the stock mid-pipe clamp, then remove the stand-off bolt and bracket bolt that supports the muffler.
6. Remove stock muffler and clamp from the stock head pipe.
7. Slightly loosen the stock head pipe at the cylinder head to aid in aligning the parts.

INSTALLING THE NEW TI PRO SYSTEM

1. Installer must use supplied hardware.
2. Slide mid-pipe onto head pipe. Rotate the mid-pipe slightly to obtain proper alignment with sub-frame mount.
3. Install the OEM bolt through sub-frame into the stand-off mount on mid-pipe (Finger tight).
4. Slide the muffler onto mid-pipe, align muffler mount with the stock muffler mount hole, and install and finger tighten the supplied M8x25mm bolt.
5. Once you have the system fully aligned, install and tighten all the bolts securely to factory specifications.

6. Replace the side panel and secure the mounting bolts.
7. Re-tighten stock head pipe at the cylinder head.

TEST RIDING

1. When you first ride the bike be aware that the characteristics are often quite different so start out slowly.

MAINTENANCE NOTES

1. Exhaust mufflers require regular maintenance. Service intervals for repacking will vary with each application. Vance & Hines recommends repacking your muffler every 10 to 15 hours to ensure the system keeps running the way it was designed. Muffler repacking kits are available (see accessories section on page 2). This service interval will vary depending upon the speed, jetting specifications and the conditions in which you ride.
2. When washing your machine, we recommend that the end cap be covered to prevent water from entering into muffler and damaging the silencer packing.

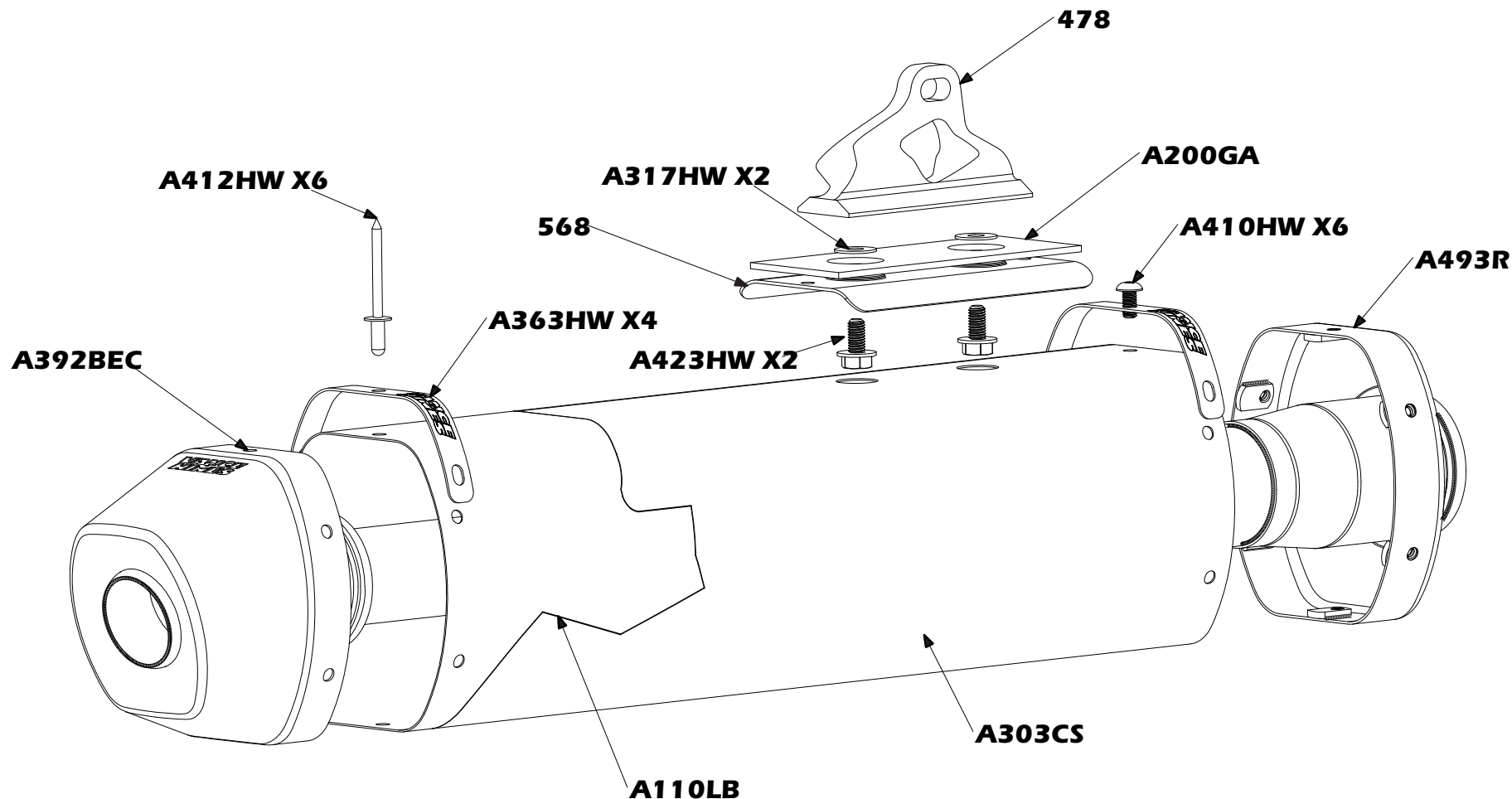

VANCE & HINES OPTIONAL ACCESSORIES

FUELPAK



For Fuel Injected models, maximize the efficiency of your improved air flow with properly managed fuel delivery by Fuelpak. Take the guess work out of fuel injection with Fuelpak Fuel Management. Contact your local dealer or call (562) 921-0071 to order. Visit fuelpakfi.com for more information. Fuelpak is intended for racing or off-highway use only, and is not legal for sale or use in California on pollution-controlled vehicles.

SPARE PARTS & ACCESSORIES

1. Muffler Re-Pack Kit (Loose Fill) P/N: 21887
2. Muffler Re-Pack Kit (Pillow pack) P/N: A234FG-R

WARRANTY

All of our exhaust systems are warranted against defects in material and/or workmanship for a period of 90 days. This warranty shall be limited to the repair or replacement of the system, which may be proven defective under normal use. We will not warranty any system that has been abused, misused, improperly installed, or modified. Failure to follow muffler packing instructions and maintenance will also not be covered under warranty.