

Congratulations, you have purchased the finest exhaust system for your motorcycle on the market. Your Vance & Hines exhaust system is designed and crafted for maximum performance, a perfect fit, a great sound and unbeatable style. Please follow the installation instructions below and if you have any questions, please call our technical support line at (562) 926-5291.

Attention installer (if other than owner), please forward this instruction sheet to the owner of this product. These instructions contain valuable information to the end user.

**TOOLS
REQUIRED**

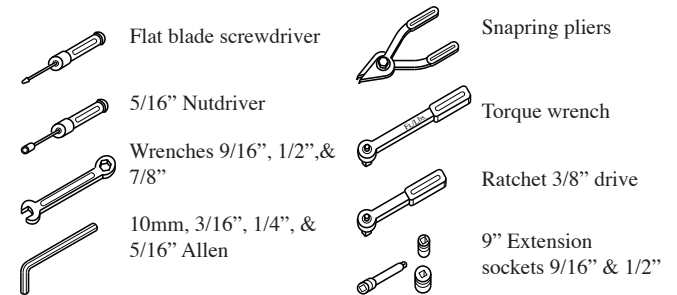

READ ALL INSTRUCTIONS BEFORE BEGINNING INSTALLATION

**STOCK EXHAUST
SYSTEM REMOVAL**

1. Remove seat to gain access to rear oxygen sensor connector. Unplug sensor and feed end of wire through frame to free it from motorcycle. NOTE: Pay attention to wire routing for re-installation.
2. Remove two bolts holding rectifier onto front of frame (near front tire). Open plastic cover to gain access to front oxygen sensor connector. Unplug sensor from harness and feed end of wire through to free it from motorcycle.
3. Loosen heat shield clamps on both the front and rear head pipes.
4. If equipped, remove front head pipe clamp carriage bolt.
5. Remove the bolt that attaches mufflers to the frame mounting bar.
6. Remove two cylinder exhaust port flange nuts from each head pipe, located at the cylinder head.
7. Remove the complete exhaust system and set aside (Assistance may be required).
8. Remove stock mounting bar and the studs in the transmission cover.
9. Remove bolts below the transmission cover. Position mounting bracket 778-P over mounting location to determine which bolts to remove (Figure 1). Re-install the OE bolt back in the un-used hole of the new bracket.
10. Carefully remove the flanges and circlips from the stock exhaust system using snapping pliers. NOTE: Replace bent or damaged circlips.
11. Remove two bolts holding mid control assembly on and let hang aside.
12. Remove stock exhaust gaskets and replace them with the supplied exhaust gaskets. NOTE: Replacement gaskets, Harley-Davidson Screaming Eagle #17048-98 or equivalent
13. Remove stock oxygen sensors, set them aside. They will be installed in the new system.

PLEASE NOTE: System will not fit with Forward Controls!

FIGURE 1

Install mount
Bracket 778-P

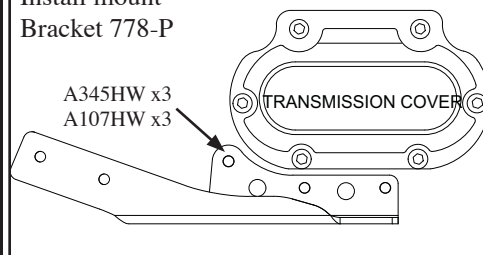
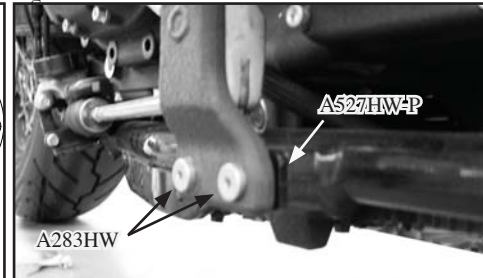

Figure 2



1. Install and tighten supplied mounting bracket (stamped 778-P) using supplied three 5/16" x 1 1/2" hex bolts and washers (Figure1). Torque to 13 to 18 Ft/Lbs.
 2. Sandwich floor board spacer (A527HW-P) between mid control assembly and frame. Tighten with two supplied 3/8" Low profile bolts (A283HW). (Figure 2)
 3. Carefully unpack both headers (R150FB, R155FB) and muffler body (R150RB) from their protective packaging and place them on a non-abrasive surface such as a blanket or carpet.
 4. Install circlips and flanges from stock system onto both new head pipes.
 5. Install stock O2 sensor into bungs and tighten. (*)
 6. Check Torque on stainless steel plugs with copper washers into both front and rear headers at the bung opening.(18mm at 30-44 ft/lbs / 12mm at 14ft/lbs)
 7. Install the rear header heat shield (R155HB) by laying the rear pipe into the heat shield and loosely install the #24 hose clamps into the mounting clips. NOTE: Screw heads should point up for access when the system is installed. Do not yet tighten.
 8. Repeat step 6 for installation of front header heat shield (R150HB).
 9. Carefully install new exhaust port gaskets (supplied) into both front and rear exhaust ports. Be sure to evenly insert each gasket into port opening.
 10. Using stock flange nuts, carefully install head pipes into exhaust ports. NOTE: Do not tighten at this time.
 11. Slip the muffler/collector assembly onto the head pipes, secure with the supplied springs using a spring puller tool.
 12. Align the mounting bracket to the megaphone, slide the nut plate inside the bracket that is welded to the backside of the muffler body and attach the muffler body to the mounting bracket using two 5/16" x 5/8" flange head bolts (supplied). Leave them loose at this time.
 13. Tighten cylinder port exhaust flange nuts on front and rear cylinders.
 14. Check alignment of muffler body then tighten the 5/16" x 5/8" flange head bolts that attach the muffler body to the bracket.
 15. Install the muffler body inlet heat shield (R131HB) with the screw heads pointing down and secure all heat shield clamps.
 16. Check for adequate clearance between all exhaust system components and motorcycle accessories prone to heat damage.
 17. Be sure to tighten all hardware before starting your motorcycle.
- (*) Model years: 2006 to 2011 uses 18mm sensors, O2 extensions may be needed / 2012 to 2013 use 12mm sensors. Installation of 18mm O2 sensor in rear headpipe is not possible when using teardrop style OEM air cleaner housing.

EXHAUST CARE - HELPFUL HINTS TO AVOID DISCOLORATION OF EXHAUST SYSTEM

1. When installing new set of stainless pipes, make sure your hands are clean and free of oil. After installation, thoroughly clean pipes with a soft cloth and cleaning solvent that will leave no residue (acetone, glass cleaner, alcohol, etc...) before starting the motorcycle.
2. It is considered normal for Stainless Steel exhaust systems to discolor due to heat.
3. High performance engine tuning utilizing a dyno will likely result in severe discoloration.
4. Avoid long periods of idling as this can cause discoloration. Intake leaks can cause the engine to run lean and overheat, this could lead to discoloration.
5. Make sure there are no exhaust leaks at the junction of the exhaust pipes and cylinder head. We recommend replacing gaskets if they are worn.

VANCE & HINES OPTIONAL ACCESSORIES

FUELPAK



FUEL MANAGEMENT:

Take the guess work out of fuel injection with Fuelpak Fuel Management. Contact your local dealer or call (562) 921-0071 to order. Visit fuelpakfi.com for more information. Fuelpak is intended for racing or off-highway use only, and is not legal for sale or use in California on pollution-controlled vehicles.

#31003 18MM O2 SENSOR ELIMINATOR KIT
#71001 18MM O2 SENSOR EXTENSION KIT

PLEASE NOTE: Every effort is made for Vance & Hines Exhaust Systems to provide improved cornering clearance. However, due to design and space limitations on some motorcycle models, ground and cornering clearance may not be improved and in some cases may be reduced. Be sure to follow proper installation instructions.

PACKING LIST

ALL PARTS SHOWN ARE ACTUAL SIZE

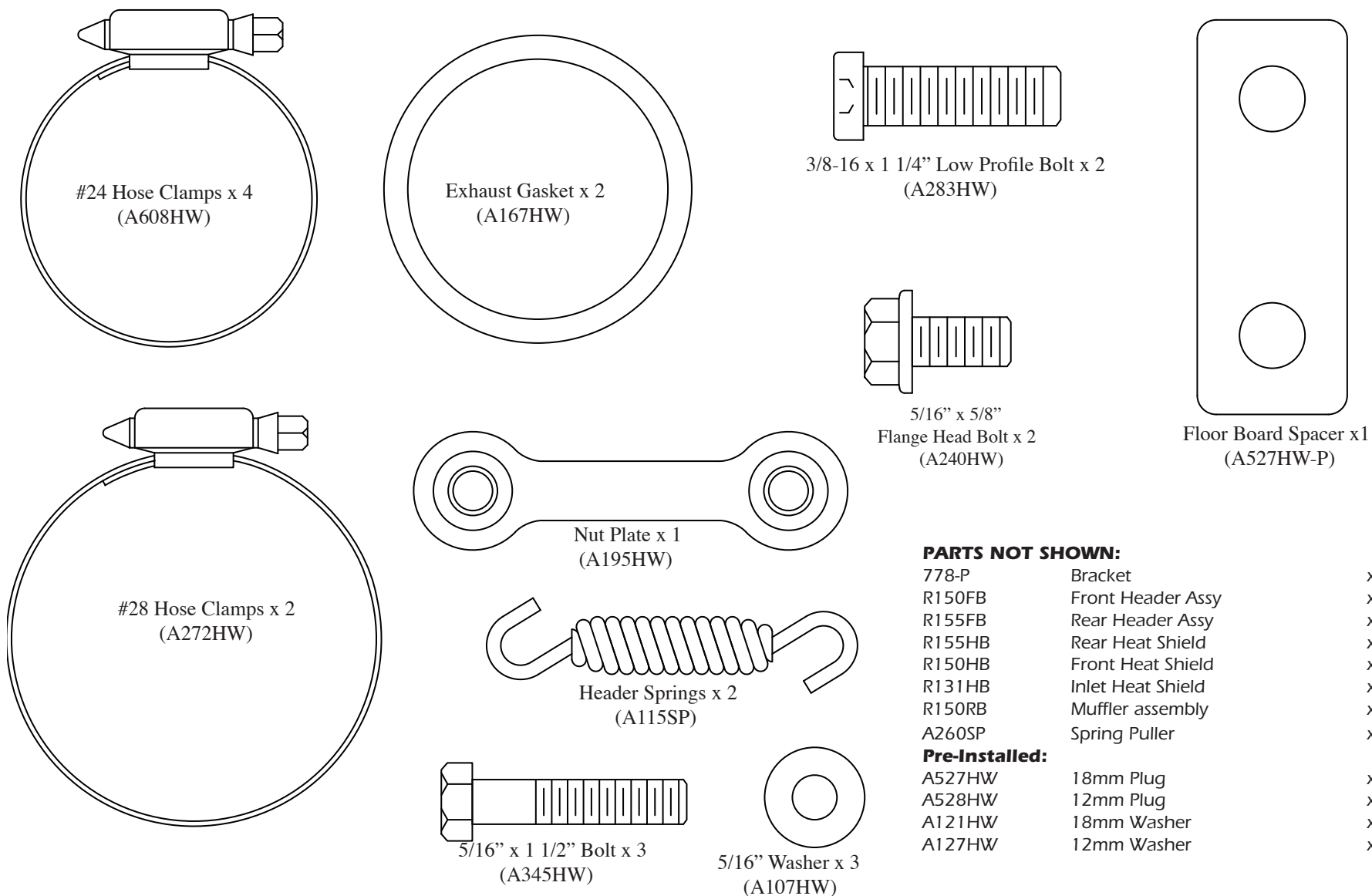

PARTS NOT SHOWN:

778-P	Bracket	x1
R150FB	Front Header Assy	x1
R155FB	Rear Header Assy	x1
R155HB	Rear Heat Shield	x1
R150HB	Front Heat Shield	x1
R131HB	Inlet Heat Shield	x1
R150RB	Muffler assembly	x1
A260SP	Spring Puller	x1

Pre-Installed:

A527HW	18mm Plug	x2
A528HW	12mm Plug	x2
A121HW	18mm Washer	x2
A127HW	12mm Washer	x2

WARRANTY

Vance & Hines exhaust systems are warranted against defects in material and workmanship for a period of 90 days from the date of purchase from an authorized dealer. This warranty does not cover discoloration of chrome finishes. This warranty is limited to the repair or replacement of a product proven to be defective from normal use. Vance & Hines exhaust systems are designed to fit and operate on OEM motor and chassis. This warranty does not cover any product subject to abuse, misuse, improper installation or modification.

GET THE MOST OUT OF YOUR RIDING EXPERIENCE...

AN AFTERMARKET EXHAUST SYSTEM IS ONLY YOUR FIRST STEP, NOW YOU NEED FUEL MANAGEMENT.

NOW YOU NEED FUELPAK.

Your fuel injected Harley-Davidson® is equipped with an ECU (electronic control unit) that's programmed to deliver fuel to the motor based on an air/fuel ratio for a stock air filter and stock exhaust system. When you install a performance exhaust system, your airflow changes, so you need a fuel management system that adjusts your air/fuel ratio to match the changes. That fuel management system is Fuelpak. Fuelpak adds and takes away fuel, allowing for a more precise range of refinement in your air/fuel ratio. Get the perfect fuel management combination with your Vance & Hines exhaust system, get Fuelpak. For more information visit the tuning center at fuelpakfi.com

NOTICE: Fuelpak is intended for racing or off-highway use only, and is not legal for sale or use in California on pollution-controlled vehicles.

