



Part Number 75-110-4 V-Rod Muscle 2:1 Competition Series Exhaust System (09-10)

Congratulations, you have purchased the finest exhaust system available for your motorcycle. Your Vance & Hines exhaust is designed and crafted for maximum performance, a great sound and unbeatable style. Please follow the instructions below, check exhaust system for missing or damaged parts and if you need any assistance please contact our technical support line (562) 921-7461.

ATTENTION:

This exhaust system is for racing purposes only. Must use early model #65109-01 exhaust gaskets and **NOT** the Muscle #64971-09 exhaust gaskets.

STOCK EXHAUST SYSTEM REMOVAL

Please remove the following:

1. To remove the stock mufflers loosen and remove the two nuts holding the muffler to the passenger foot-peg. Remove foot-peg and stud assembly from the rubber grommets and set aside. Loosen and remove the single nut towards rear of the muffler which holds the muffler to the round bar section of the foot-peg/exhaust bracket. Loosen the muffler clamp that holds the muffler to the head pipe. Loosen all heat shield clamps and remove heat shields from pipes. Pull muffler away from head pipe and set aside. Repeat for both sides.
2. Remove Foot-peg/exhaust bracket by removing the three allen bolts holding the bracket to the frame, set bracket aside. Repeat for both sides.
3. Remove rear pipe by removing the three allen screws that hold on the pulley/belt cover to gain access to exhaust flange nuts. Loosen and remove the two exhaust flange nuts. Loosen the crossover pipe clamp. Disconnect the O² sensor wire by following the wire to the connector underneath the seat. Unplug the connector and pull wire free from all clamps. Remove pipe and set aside. If using a Power Commander install O² eliminator now.
4. Disconnect front O² sensor plug by removing the allen screw on bottom of the left side radiator cowl, pull downward at the bottom of the cowl to free from pin and then lift at the top of the cowl to free from another pin, set cowl aside.
Note: Do not use excessive force on the cowl panel or damage may result.
5. Remove front cylinder pipe by loosening exhaust flange nuts. Carefully remove pipe from bike. If using a Power Commander install O² eliminator now and reinstall cowl panel.
6. Remove the passenger peg from the original mounts using a snapping pliers, be careful to not overexpand the circlip.
7. Carefully remove the stock exhaust flanges and circlips from the front and rear head pipes.

If the exhaust circlips are bent or twisted they should be replaced, Harley-Davidson part number #65045-01
Replace the stock exhaust gaskets with Harley-Davidson part number #65109-01

COMPETITION SERIES EXHAUST SYSTEM INSTALLATION

1. Locate left foot-peg mount (with spacer) D236MB install using one M8 x 25mm socket head cap screw and a M8 x 50mm socket head cap screw supplied. Use a medium strength loctite® and torque to 18 ft/lbs refer to (Figure 1), repeat for the right side refer to (Figure 2).
2. Reinstall the original passenger pegs removed earlier on to the new foot-peg mounts.
3. Identify front head pipe D208FB. Install the stock flange and circlip, install head pipe leaving the flange nuts hand tight.
4. Repeat the above step for the rear head pipe D209FB.
5. Install megaphone mounting bracket 676-P (with grommet) to the megaphone with two 5/16 flange bolts and dog bone nut plate supplied. First slide the dog bone nut plate inside the bracket welded to the back of the megaphone then attach and align bracket refer to (Figure 2), leave the bolts hand tight at this time.
6. Slip the megaphone/collector assembly onto the head pipes. Align megaphone mounting bracket refer to (Figure 2) install using the remaining M8 x 25mm socket head cap screw and a flat washer on each side of the grommet use a medium strength loctite® and torque to 18 ft/lbs.
7. Rotate the exhaust so there is adequate clearance in all places. Clearance at the clutch cover should be at least 1/4".



Figure 1



Figure 2



Figure 3



Figure 4

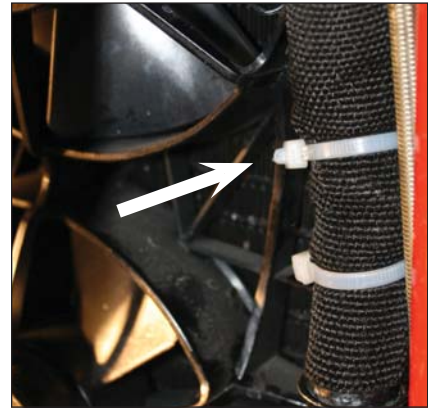

Figure 5

8. Tighten the cylinder head flange nuts for both the front and rear head pipes. Tighten the two 5/16 flange bolts supporting the megaphone mounting bracket.
9. If using a Power Commander with O² eliminators tighten the O² plugs on the front and rear head pipes.
10. If using a fuel management system that requires the stock O² sensors remove them from the stock head pipes and reinstall, due to O² sensors location it will be necessary to swap front and rear O² sensors. Reroute O² sensor with longer wire to the front cylinder refer to (*Figure 3*) and O² sensor with shorter wire to the rear cylinder refer to (*Figure 4*).
11. Make sure the oil line is not touching the front head pipe. If necessary, loosen the ties and rotate the oil line away from head pipe, re-tie the oil line to the fan mount refer to (*Figure 5*).
12. Clean all fingerprints from the exhaust using a contact cleaner (or other non flammable cleaner). Fingerprints will leave stains on the pipe once the motorcycle is started.
13. You are now ready to start the motorcycle.

Note: After initial ride it is recommended to re-torque the baffle screw to 8-10 lb. using a 5/32" allen wrench and retighten the cylinder head flange nuts.

For best results, we recommend fuel injection mapping for your new combination using a Fuelpak or Power Commander. Settings for the Fuelpak and some Power Commander maps are available on our website at www.vanceandhines.com

Vance & Hines

13861 Rosecrans Ave, Santa Fe Springs, CA 90670

Phone: (562) 921-7461, Fax: (562) 802-0110

E-mail: sales@vanceandhines.com

Web: www.vanceandhines.com

Opening Hours – Monday through Friday, 8am – 5pm, Pacific Standard Time

Vance & Hines exhaust systems are warranted against defects in material and workmanship for a period of 90 days from the date of purchase from an authorized dealer. This warranty does not cover discoloration of any coated finishes. This warranty is limited to the repair or replacement of a product proven to be defective from normal use. Vance & Hines exhaust systems are designed to fit and operate on OEM motor and chassis. This warranty does not cover any product subject to abuse, misuse, improper installation or modification.

75-110-4 V-ROD MUSCLE 2:1 COMPETITION SERIES EXHAUST SYSTEM

75-110-4 PARTS LIST		
PART NO.	DESCRIPTION	QTY.
D208FB	Front Pipe Assy.	1
D209FB	Rear Pipe Assy.	1
A213HW	O ² Sensor Plug 18mm, Steel	2
A121HW	Washer, 24x18x1mm, Copper	2
D296RB	Megaphone	1
A205NP	Name Plate (2.5")	1
A362HW	Rivet	2
A195HW	Dog Bone Nut Plate	1
A240HW	HCS, 5/16-18 x 5/8	2
662	Meg. Mounting Bracket (B)	1
A204SP	Spring	2
A128BEC	Comp. Baffle End Cap, TVD-DPD	1
A127R	Welded Baffle Core Assy.	1
A445HW	BHCS 1/4"-20 x 5/8", Zinc	1
A112HW	Flat Washer Zinc, 1/4"	2
A115HW	Lock Washer Zinc, 1/4"	2
A235HW	BHCS 1/4"-20 x 1/2", Zinc	1
676-P	Meg. Mounting Bracket (A)	1
A428HW	Bolt, M8x1.25x25mm	4
A245HW	Rubber Grommet MS	1
C906	Exhaust Mount Isolator Spacer	1
22683	Washer, 5/16x13/16x.055 Thk	2
A444HW	18-8 SS Capscrew 10-32, 3/8"	3
D236MB	Muscle Lt Footpeg Bracket	1
A210HW	Bolt, M8 x 1.25 x 50mm	1
D235MB	Muscle Rt Footpeg Bracket	1
A267FG	Baffle Sock	1
A260SP	Exhaust Spring Puller Tool	1

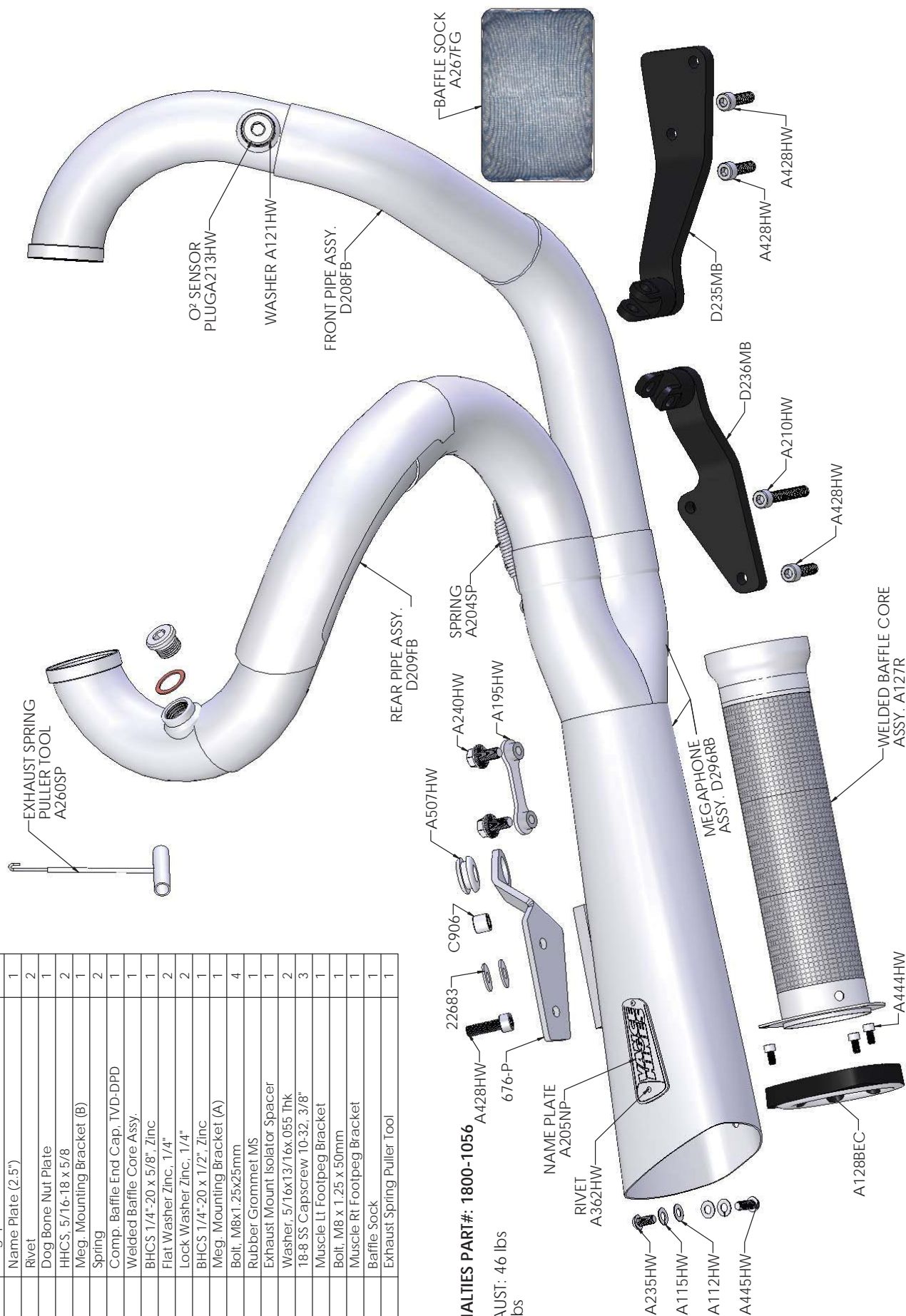

DRAG SPECIALTIES PART#: 1800-1056

STOCK EXHAUST: 46 lbs
75-106-4: 8 lbs