

INSTALLATION INSTRUCTIONS: HARLEY-DAVIDSON UPSWEEP AIR COVER KIT PART# 71045/71047

Congratulations, you have purchased the finest air intake system for your motorcycle on the market. Your Vance & Hines Air Intake system is designed and crafted for maximum performance and a perfect fit. Please follow the installation instructions below and if you have any questions, please call our technical support line at (562) 926-5291.

PARTS LIST

ITEM NO.	PART NO.	DESCRIPTION	QTY.
1	A204HW	3/8-16 x 7/8" BHCS	3
2	D220CV/D225CV	Air Cleaner Cover	1
3	A420HW	5/16-18 x 1-1/4" BHCS	1
4	607-P	Mounting Plate	1
5	A710ST-A	Spacer	1

(AIR CLEANER NOT INCLUDED)

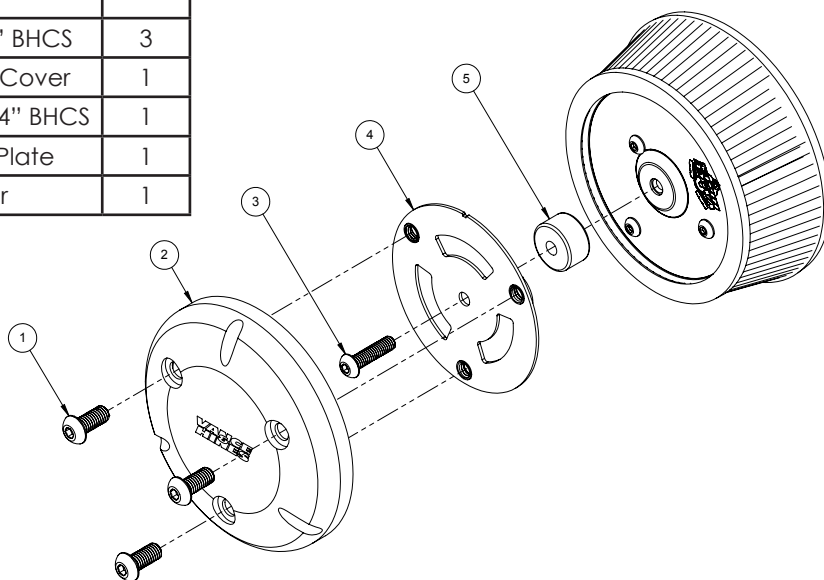

TOOLS REQUIRED

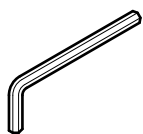

Allen Wrench: 5/32",
3/16", 7/32"

Loctite 243 (blue)

INSTALLATION OF UPSWEEP AIR COVER

NOTE: This cover fits Vance and Hines Naked Air Filter Kits and HD Screamin' Eagle Air Filter Kits using the 5-1/2" round air filter with center mount hole.

1. For a clear understanding of this installation it is best to refer to the exploded view diagram while reading these instructions.
2. When installing or servicing the air cleaner, apply Loctite 243 (blue) to threads of all fasteners.
3. Feed the 5/16"-18 x 1.25" button head cap screw (3) through the mounting plate assembly (4) and the aluminum spacer (5) and into the center of the air filter element as shown in the exploded view. Tighten securely. **NOTE:** Align one weld nut at approximately six o'clock when viewed from the side.
4. Feed the three 3/8"-16 x 7/8" button head cap screws (1) through the air cover (2) and into the mounting plate assembly. Tighten securely.
5. After 100 miles check to be sure that all bolts are still tight. Periodically ensure that all fasteners remain tight.

Emissions Notice:

In California, in order to meet Air Resources Board emissions requirements, certain aftermarket part applications have been identified as replacements, and others have received ARB Executive Orders. All other emissions related aftermarket parts are for competition use only. A list of replacement parts and EO parts, and corresponding fitment is provided at vanceandhines.com/california.

Warranty:

All Vance & Hines products are warranted against defects in material and workmanship for a period of 90 days. This warranty does not cover discoloration or rust. This warranty shall be limited to the repair or replacement of the product, which may be proven defective under normal use. Vance & Hines will not warranty any system that has been abused, misused, improperly installed or modified.

Dealers or distributors are not authorized to make dispositions binding upon Vance & Hines. Vance & Hines will not be responsible for any labor charges incurred in removing or replacing any system under warranty. A return authorization number and a copy of the original purchase invoice must accompany all returns. Parts returned without a return authorization may be refused.

13861 ROSECRANS AVENUE / SANTA FE SPRINGS, CA 90670

SALES: (562) 921-5388

TECHNICAL: (562) 926-5291

FAX: (562) 802-0110

vanceandhines
.com